

One and Six Year Plan

2018

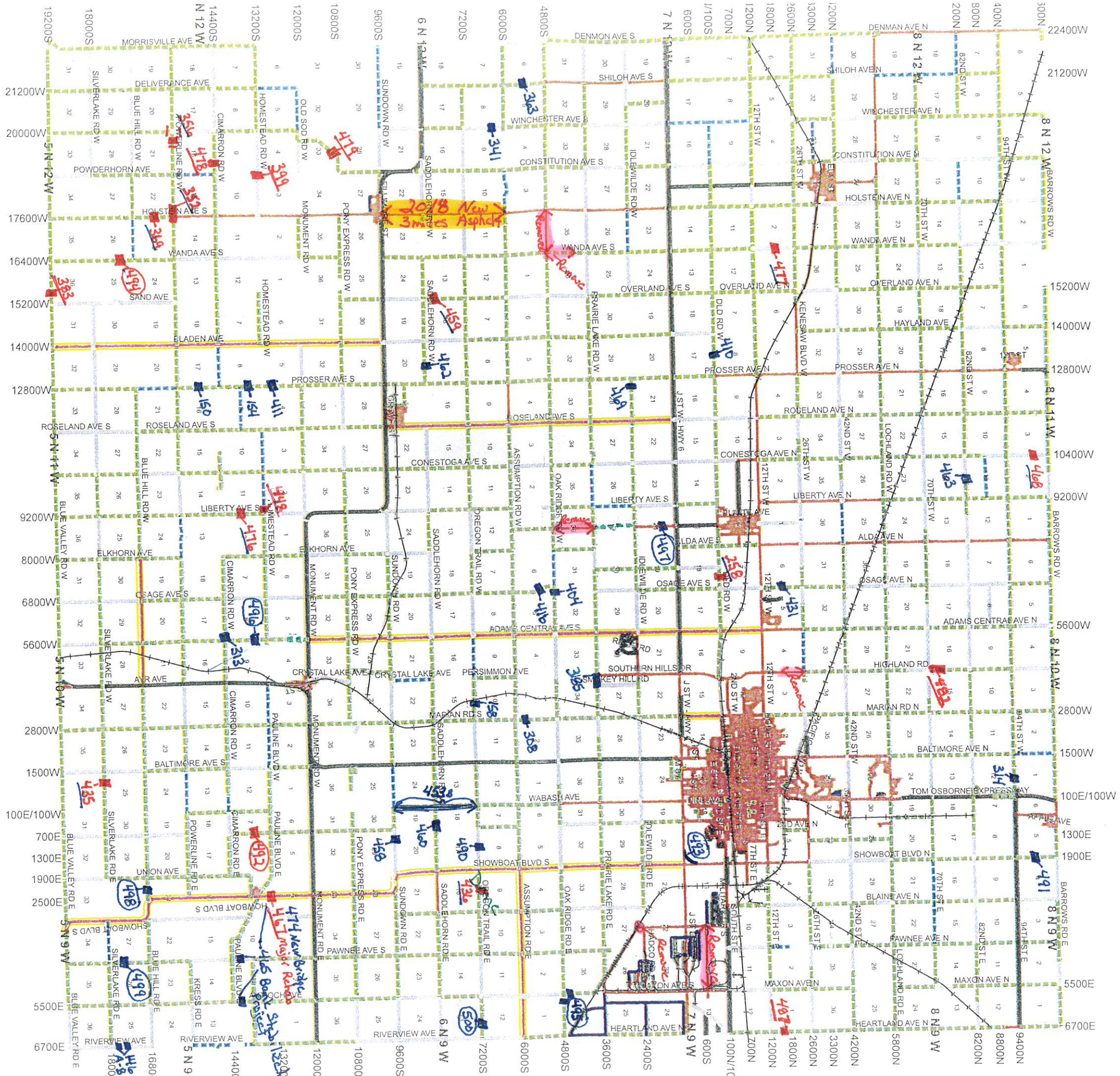

Roads	
<all other values>	GRAVEL
DORSURFACE	HIGHWAY
ASPHALT	MIN MAINT
BITUMINOUS	PAVED
CONCRETE	PRIVATE
	TOWNSHIP
	VILLAGE

2018 1 Yr. Projects = 19 + 3 miles New Asphalt
 2018-2024 6 Yr Plan = 32 + 5 miles Old Asphalt "milk-up"/Remove
 + 1- Proj: 436 Dowe Jan. 2018
 Added 2 New Projects to Plan after Advancing 10 projects to 2018 1 Yr. Plan

○ around Proj. Number = New Project to 1 or 6 Yr. Plan
 — line under Proj. Number = Advanced from 2011 to 4 yr to 2018 1 Yr. Plan

